

A SECTION
E2 1:125
WEST ELEVATION

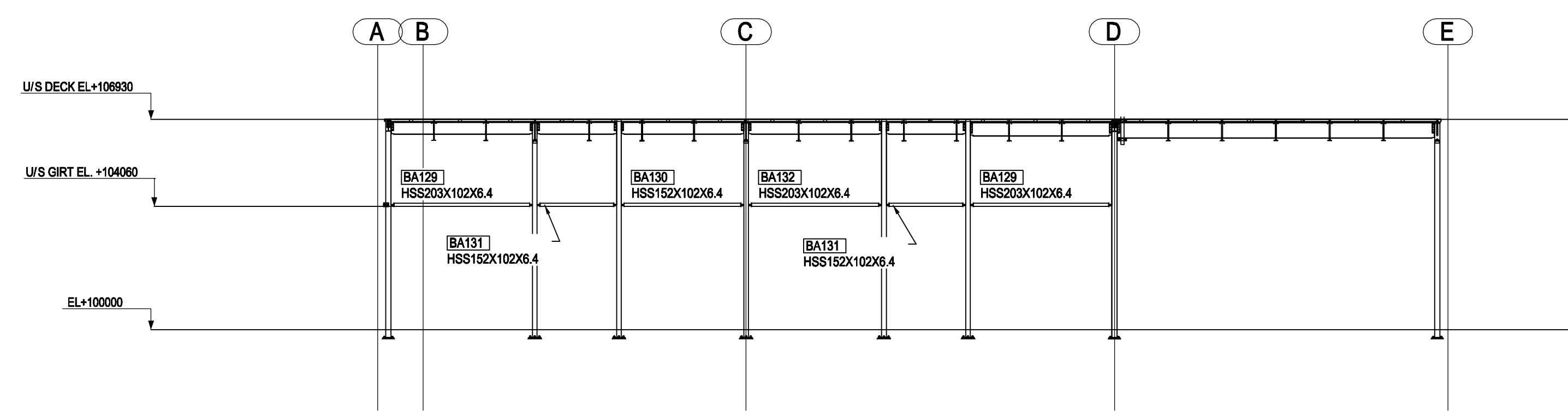

B SECTION
E2 1:125
SOUTH ELEVATION

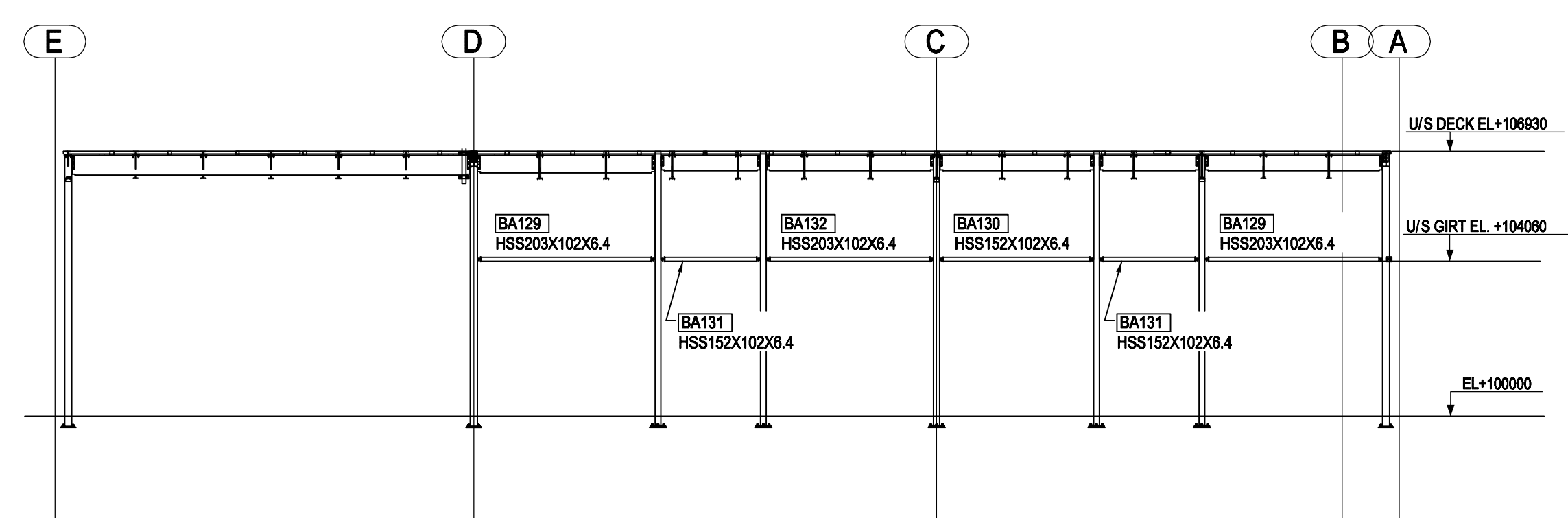

C SECTION
E2 1:125
NORTH ELEVATION

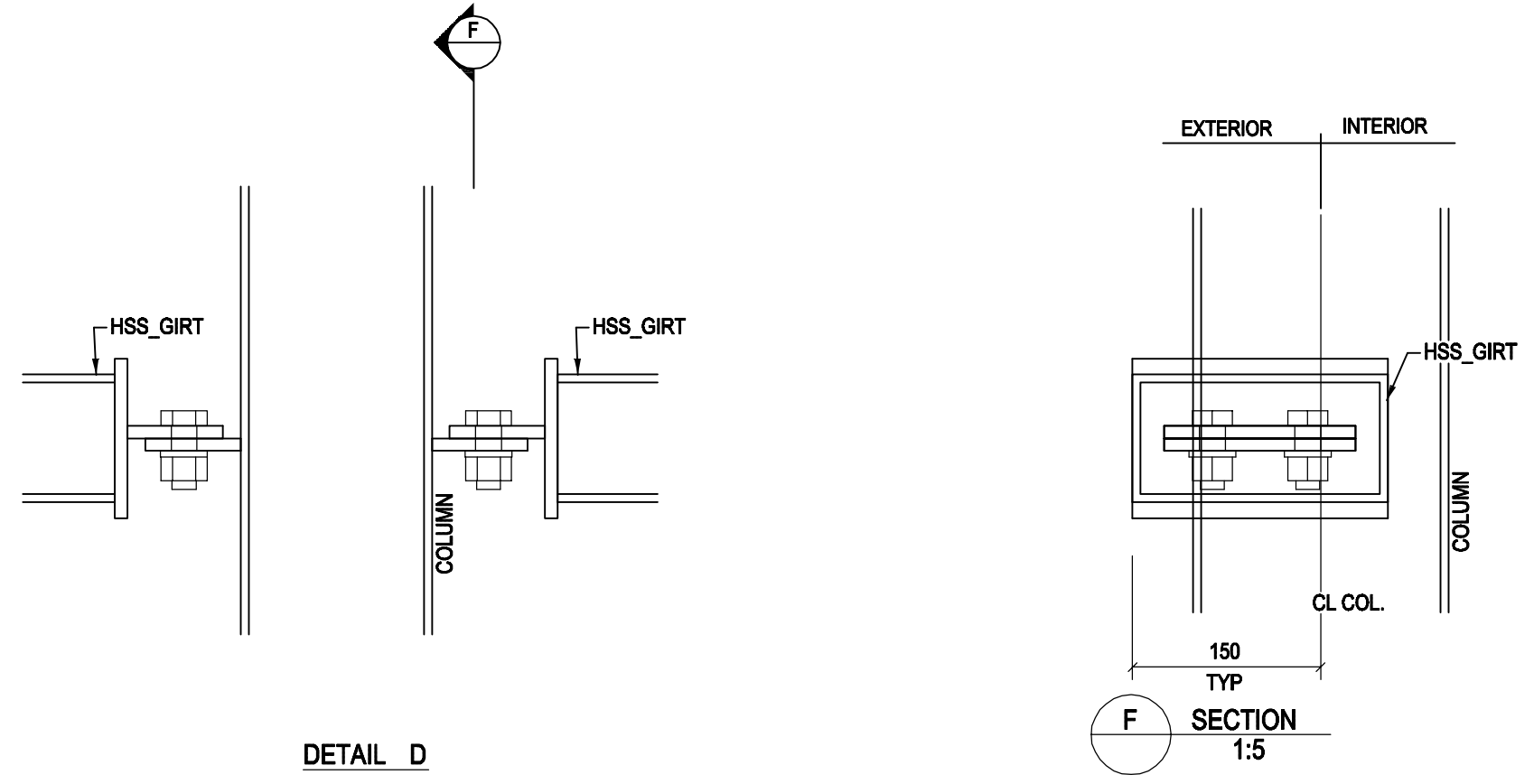

DETAIL D

F SECTION
1:5

MATERIAL SPECIFICATIONS UNLESS NOTED:
 CHANNELS, ANGLES, PLATES & FLAT BARS TO CSA G40.21M-300W
 WIDE FLANGE SHAPES TO CSA G40.21M-350W
 HOLLOW STRUCTURAL SECTIONS TO CSA G40.21M-350W CLASS C
 PIPE SECTIONS TO ASTM A53 GRADE B.

0			FOR CONSTRUCTION
A			FOR APPROVAL
Index	Author	Date	Description

ADDRESS:

CUST REF:			
PAINT: GREY	CUSTOMER:		
HOLES: 13/16"	CONTRACT:		
DETAIL: ELEVATIONS			
DRWN BY	CHK BY	CONTRACT NO.	DRAWING NO.
DATE	DATE		E3